

Soils Map

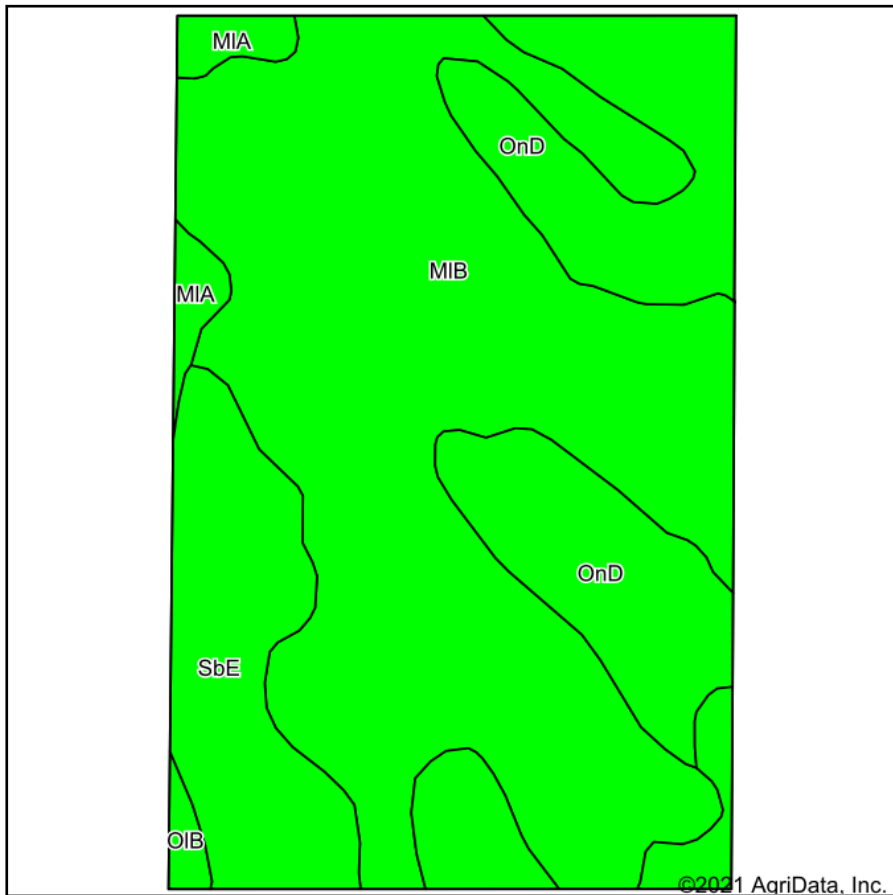

Soils data provided by USDA and NRCS.

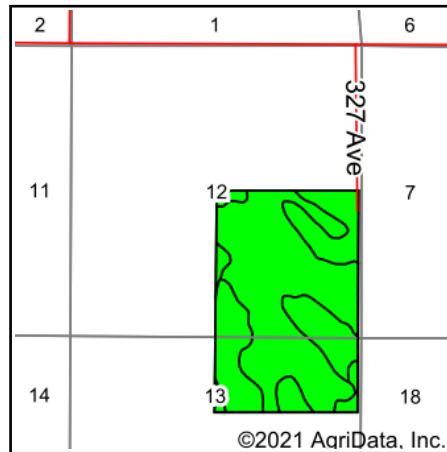

State: **South Dakota**
 County: **Lyman**
 Location: **12-104N-74W**
 Township: **Bailey**
 Acres: **240**
 Date: **1/10/2021**



Maps Provided By:



© AgriData, Inc. 2020

www.AgriDataInc.com



Code	Soil Description	Acres	Percent of field	PI Legend	Non-Irr Class *c	Irr Class *c	Range Production (lbs/acre/yr)	Productivity Index	*n NCCPI Overall	*n NCCPI Corn	*n NCCPI Small Grains	*n NCCPI Soybeans
MIB	Millboro silty clay loam, 3 to 6 percent slopes	142.44	59.4%		Ile	Ile	2785	82	33	20	23	33
OnD	Opal-Sansarc clays, 6 to 15% slopes	49.32	20.5%		Vle	Vle	2230	38	17	8	15	17
SbE	Sansarc-Opal clays, 9 to 25 percent slopes	40.94	17.1%		Vlle	Vlle	2003	21	14	6	13	14
MIA	Millboro silty clay loam, 0 to 3 percent slopes	5.54	2.3%		Ils	Ils	2805	89	34	20	23	34
OIB	Opal clay, 3 to 6 percent slopes	1.76	0.7%		IIle	IIle	2454	60	20	9	17	20
Weighted Average							2535.6	62.6	*n 26.4	*n 15.1	*n 19.6	*n 26.4

*n: The aggregation method is "Weighted Average using all components"

*c: Using Capabilities Class Dominant Condition Aggregation Method

Soils data provided by USDA and NRCS.